

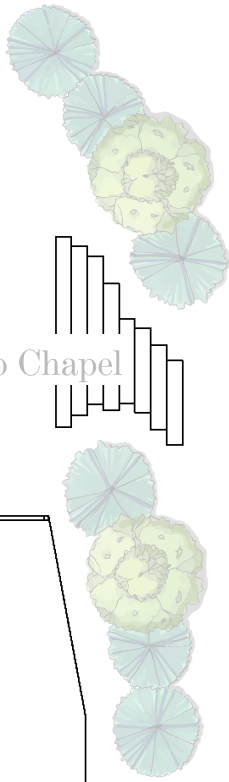

Gathering Hall Floor Plan



Canyon
Creek

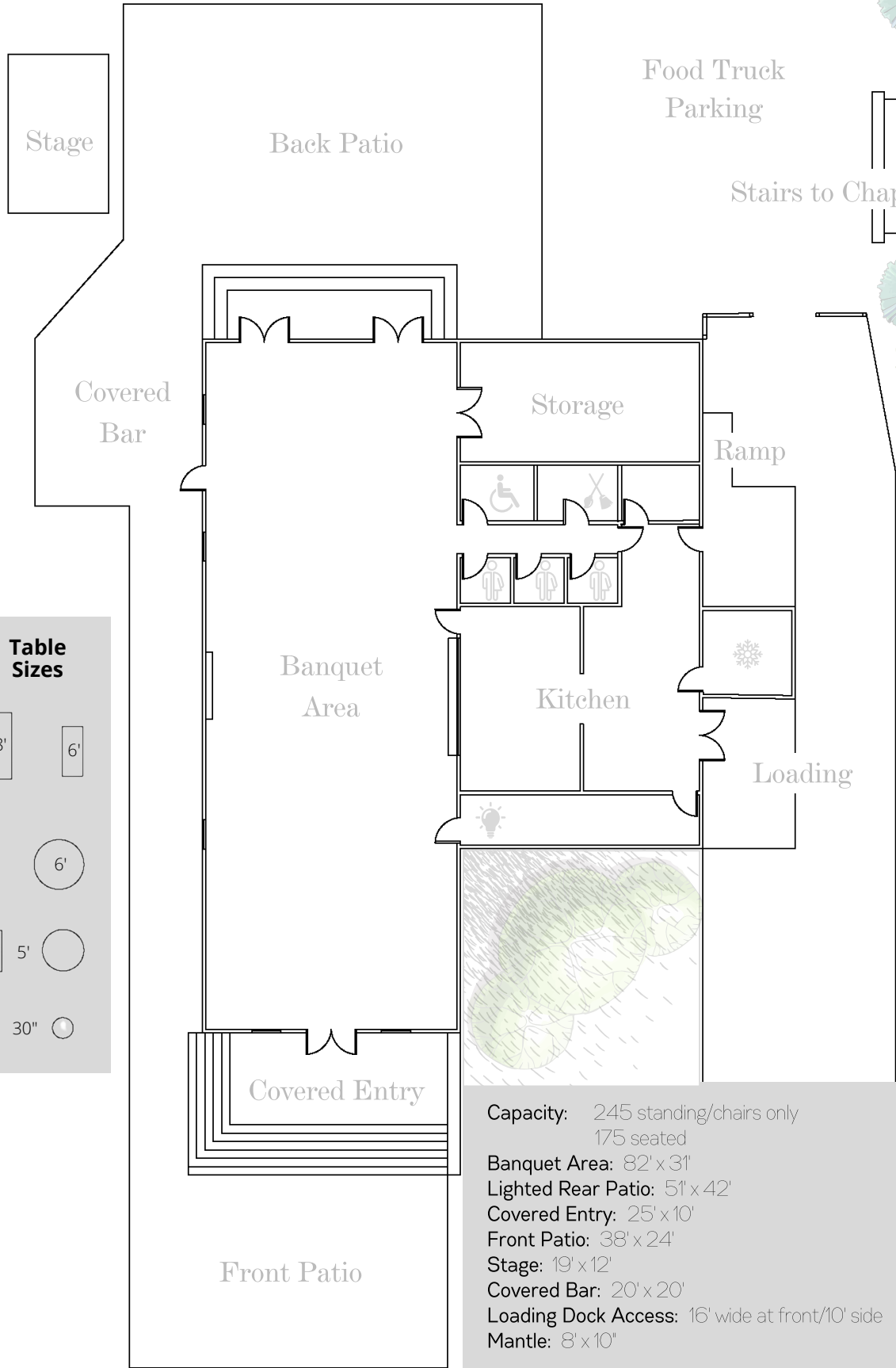

Table Sizes

- 8' (rectangle)
- 6' (rectangle)
- 6' (circle)
- 5' (circle)
- 30" (circle)

Capacity: 245 standing/chairs only
175 seated

Banquet Area: 82' x 31'

Lighted Rear Patio: 51' x 42'

Covered Entry: 25' x 10'

Front Patio: 38' x 24'

Stage: 19' x 12'

Covered Bar: 20' x 20'

Loading Dock Access: 16' wide at front/10' side

Mantle: 8' x 10"



Scale (feet)

1 5 10